

Site Plan of Lot 4, Sec 30, Tp 22, R 10, W6M, KDYD, Plan 9999

Scale 1:250 BCGS 82L.084

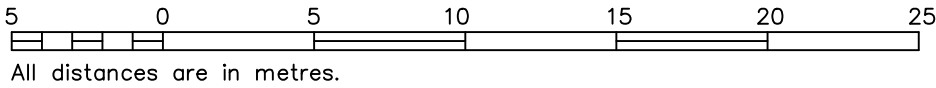

The intended plot size of this plan is 432mm in width by 560mm in height (C size) when plotted at a scale of 1:250

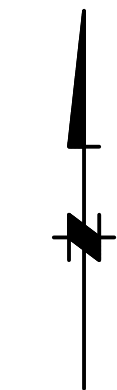

LEGEND

- Standard Iron Post Found (OIP)
- NF Denotes nothing found
- Date of Survey: November 28, 2019
- Dimensions derived from Plans 9999, KAP57437 & EPP85480

Elevations are geodetic and are derived from Natural Resource Canada's PPP GNSS processing services.
Vertical datum used: CGVD28 (HTv2.0)

Civic Address: 3304 Gray Road, Blind Bay, BC

Parcel Identifier(PID): 008-587-639

List of documents registered on title which may affect the location of improvements:
none

This plan was prepared for construction planning purposes and is for the exclusive use of our client, BROWNE JOHNSON LAND SURVEYORS accepts no responsibility or liability for any damages that may be suffered by a third party as a result of reproduction, transmission or alteration to this document without consent of BROWNE JOHNSON LAND SURVEYORS.

- power pole
- anchor
- overhead power line
- break
- break top
- break toe
- 348.7m contour
- 15.0m setback from 348.7m contour
- 30.0m setback from 348.7m contour
- 348.3m contour
- Present Natural Boundary
- retaining wall top
- retaining wall toe
- edge of gravel road
- edge of pavement
- rock retaining wall
- block retaining wall

Note: The Present Natural Boundary shown on this plan is the Lake Boundary under Common Law assuming that the boundary has moved by the natural process of erosion. If a sudden change has occurred (avalanche), the position of the boundary may be different than shown.
This plan does not serve to update Land Title Office records.

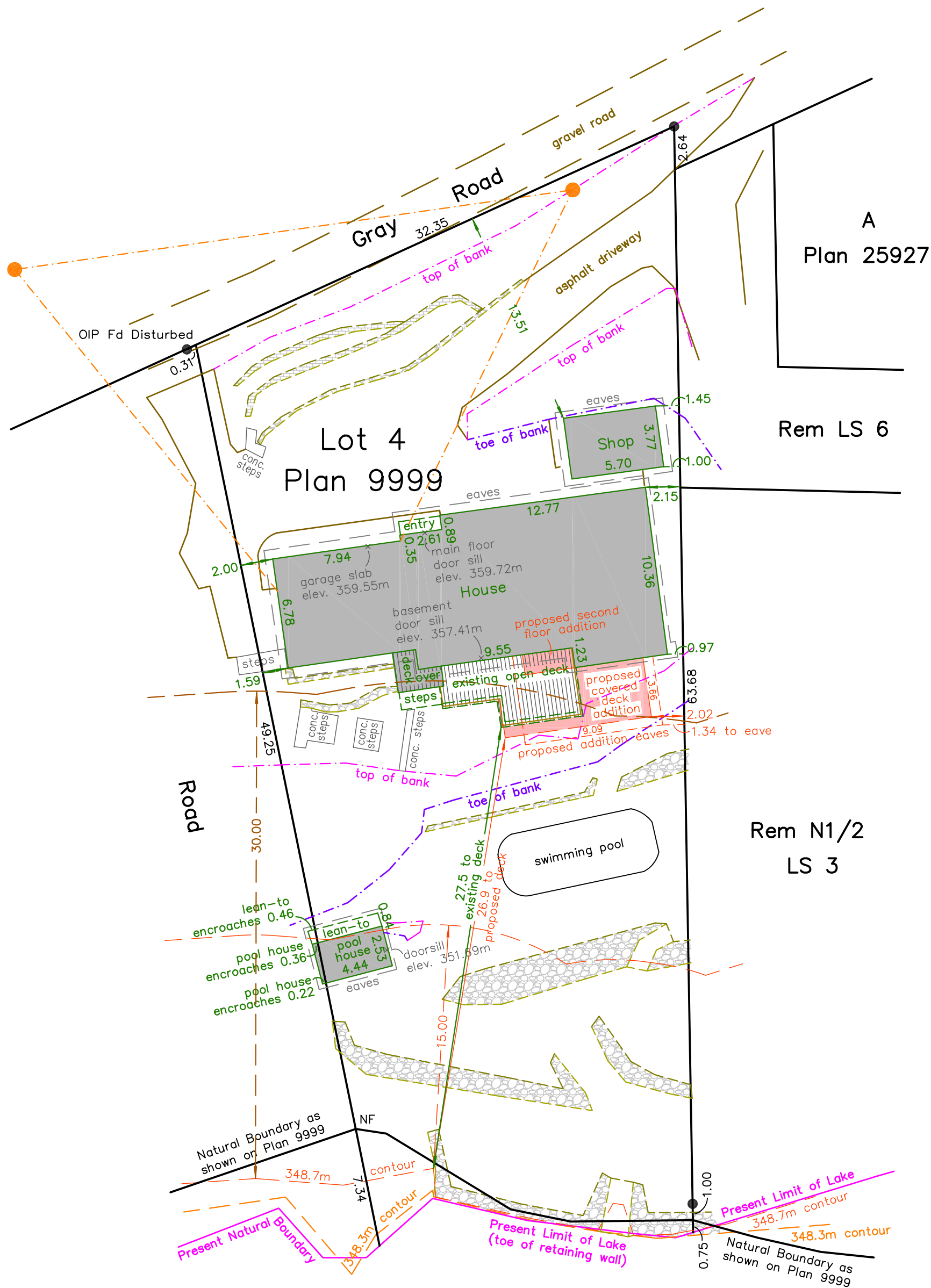

Shuswap Lake

December 9, 2019

BROWNE JOHNSON LAND SURVEYORS
B.C. AND CANADA LANDS
SALMON ARM, B.C. 250-832-9701
File: 550-19 Fb.R134 p.15
550-19.raw